



**NATIONAL
LANDING**
PENTAGON CITY
CRYSTAL CITY
POTOMAC YARD

NATIONAL LANDING TRANSPORTATION ROUNDTABLE

MARCH 9, 2022





1 WELCOME

2 NL BID PROJECTS

**3 DES PROJECT
OVERVIEW**

4 DISCUSSION/QUESTIONS

BIG MOVE – ROUTE 1 BOULEVARD

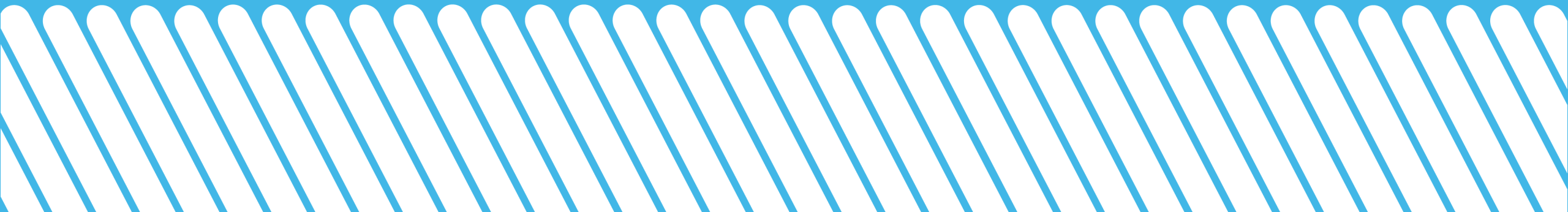

ROUTE 1 FEASIBILITY STUDY

- Vision is for a downtown community that prioritizes people over cars
- VDOT's preferred alternative of an at-grade facility is a key part of this transformation
- Design and operations, however, must go further:
 - Extend to the Alexandria border
 - Provide protected bicycle/micromobility infrastructure along and across the corridor
 - Set safe speed limit of 25MPH and embrace automated enforcement tools
 - Focus delivering wide, functional sidewalks



ROUTE 1 FEASIBILITY STUDY

PHASE 2

- Recommends converting Route 1 to an at-grade urban boulevard
- Includes provision for:
 1. A Travel Demand Management (TDM) Strategy
 2. Further study of a separate pedestrian crossing over or under Route 1 at 18th Street
- VDOT PUBLIC MEETING- April 28 at 6:30



WAYFINDING UPDATE



NL WAYFINDING ANALYSIS

Phase I

- RSM Design was selected as the consultant after a competitive RFP process
- Needs analysis & Trends analysis Reports
- Deliverables April 2022
- BID Wayfinding Committee to convene
- NLBID staffer Matt Jones, mjones@nationallanding.org



12TH AND S. FERN- PLACEMAKING



12TH & SOUTH FERN STREET



Greenery



Atmospheric lighting



Thoughtful programming

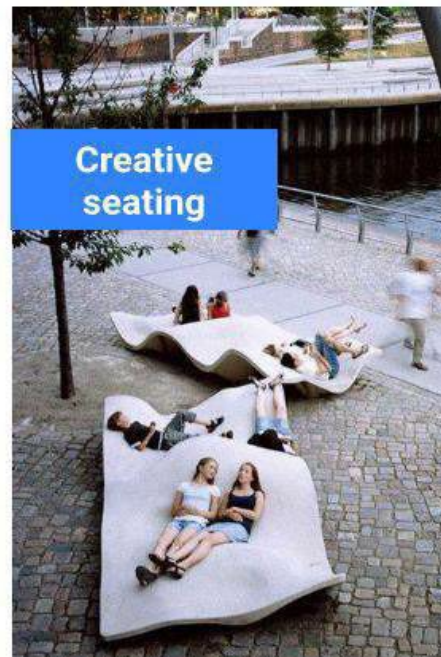

Creative seating

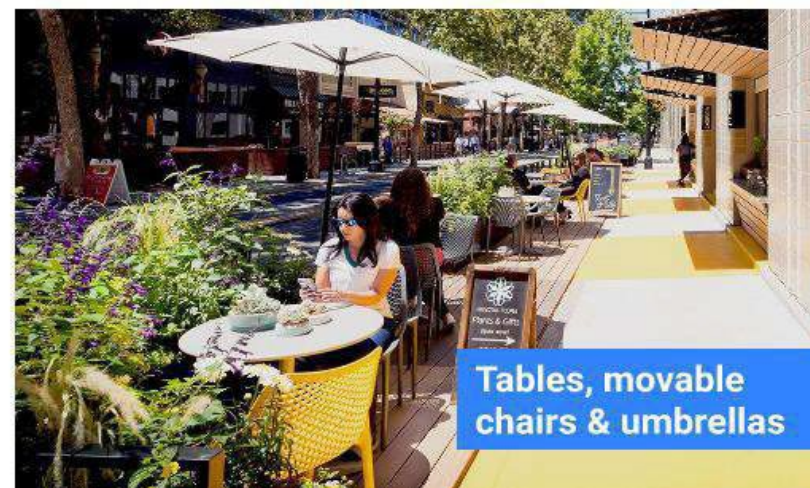

Tables, movable chairs & umbrellas

PROJECT OVERVIEW

Valerie Mosely, Transportation Team – Arlington County
Department of Environmental Services (DES)



Transportation Roundtable

National Landing BID

March 9, 2022

AGEN

DA

- Project Overview Map
- Project Updates on active projects
- Public Engagement Forecast
- Questions

Crystal City and Pentagon City: Transit & Street Network Projects

AKLINGTON



Project legend

- MA13 - Transitway Segment I - 12th street S
- CC13 - S Eads St Improvements - Phase I
- CC23 - S Eads St Improvements - Phase II
- CC13 - S Eads St Improvements - Phase III
- CC11 - 23rd Street S - Phase I
- CC20 - 18th street S Improvements
- D2S - Boundary Channel C&E (VIOT Design Build)
- CC08 - 15th street S - Clark-Bell Extension
- CC11 - 23rd Street South - Phase 0
- CF01 - Army Navy Drive
- CC16 - 12th street S Improvements
- MA13 - Transitway Segment a - 12th streets
- CC15 - National Airport Off
- CC10 - 18th street S - Bell to Crystal Drive
- CC24 - 15th Street S Complete streets Phase I
- CC25 - Army Navy Drive Protected Bike Lanes
- 20th street S - Crystal Drive to S Eads st
- 23rd street S Restaurant Block Pedestrian Improvements
- 15th Street S Complete Streets Project
- Route 1 Pedestrian Improvements
- Route 1 Rill 11S at 15th street S
- CC22 - CC2DCA Connection (Exact location Under Study)
- Route 1 Multimodal Improvements Study (VDOT)
- MA13 - Transitway Segment IV (Operations Only)
- Existing Transitway Route
- future Transitway Route
- Existing Transitway Station
- future Transitway Station

BOUNDARY CHANNEL DRIVE INTERCHANGE IMPROVEMENTS

- Project Location: Boundary Channel Drive interchange at I-395
- Project Scope: Reconfigure Boundary Channel Drive interchange to include roundabouts on either side of I-395 and bicycle/pedestrian improvements
- Underpinning Basis: MTP Bike Element #1-07
- Project Status: Design-builders approaching 90% design
- Cost: \$20.4 million
- Next Public Touchpoint: 90% Design communication, Construction alerts beginning Summer 2022



ARMY NAVY DRIVE COMPLETE STREET

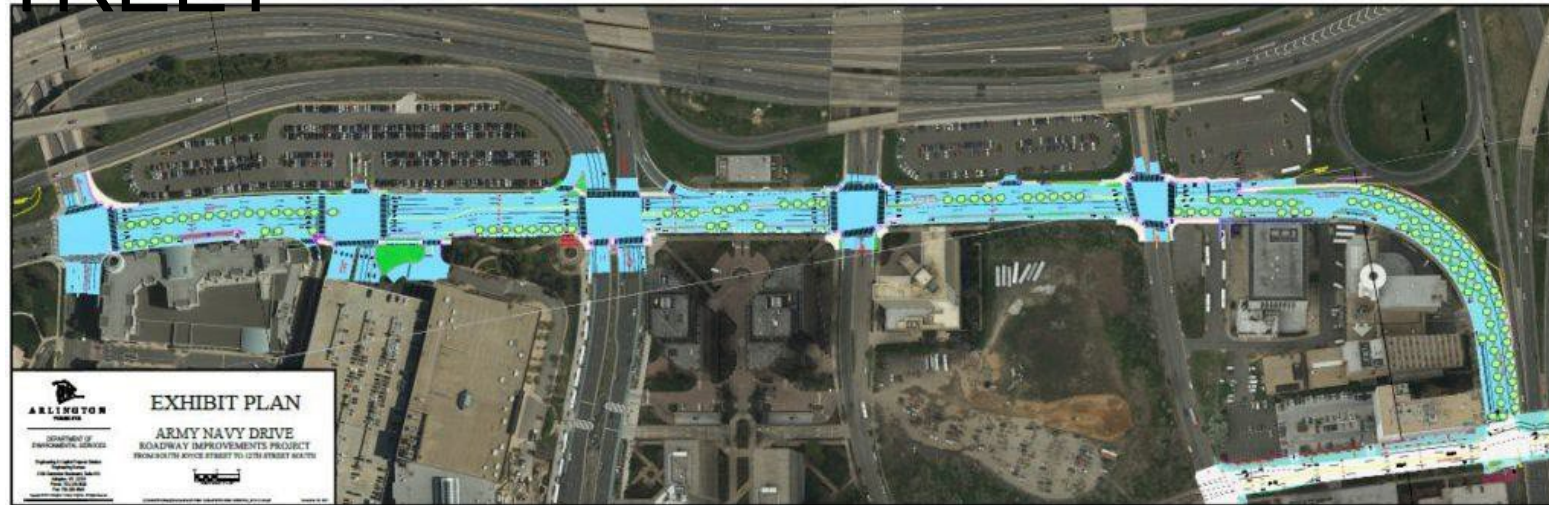

- Project Location: Army Navy Drive between S. Joyce St. and 12th St. S.
- Project Goals & Scope:
 - Redesign as a Complete Street with improved safety and travel accommodation for multi-modal users
 - Critical linkage of Crystal City transitway to Pentagon City
- Planning Basis: Crystal City Sector Plan, MTP Bike Element #1-06
- Project Status: Approved to advertise; finalizing easements prior to ITB
- Cost: \$16.1 million
- Next Public Touchpoint: County Board action on construction contract, Summer 2022

ARMY NAVY DRIVE PROTECTED BIKE LANE



- Project Location: 12th St. S. between S. Lynn St. to S. Joyce St.
- Project Goals & Scope:
 - Dovetails to fill "Missing Link" in Army Navy Complete Streets project
 - Separated, buffered bike lanes, raised planted islands, curb extensions
- Planning Basis: Pentagon City Sector Plan, MTP Bike Element
- Project Status: 30% Design through Spring 2021
- Design Development & Final Design into Winter 2022-23
- Cost: Estimated at \$4 million, locally funded, County-maintained
- Next Public Touchpoint: Communication of final concept in Fall 2022

12TH STREET SOUTH STREET IMPROVEMENTS

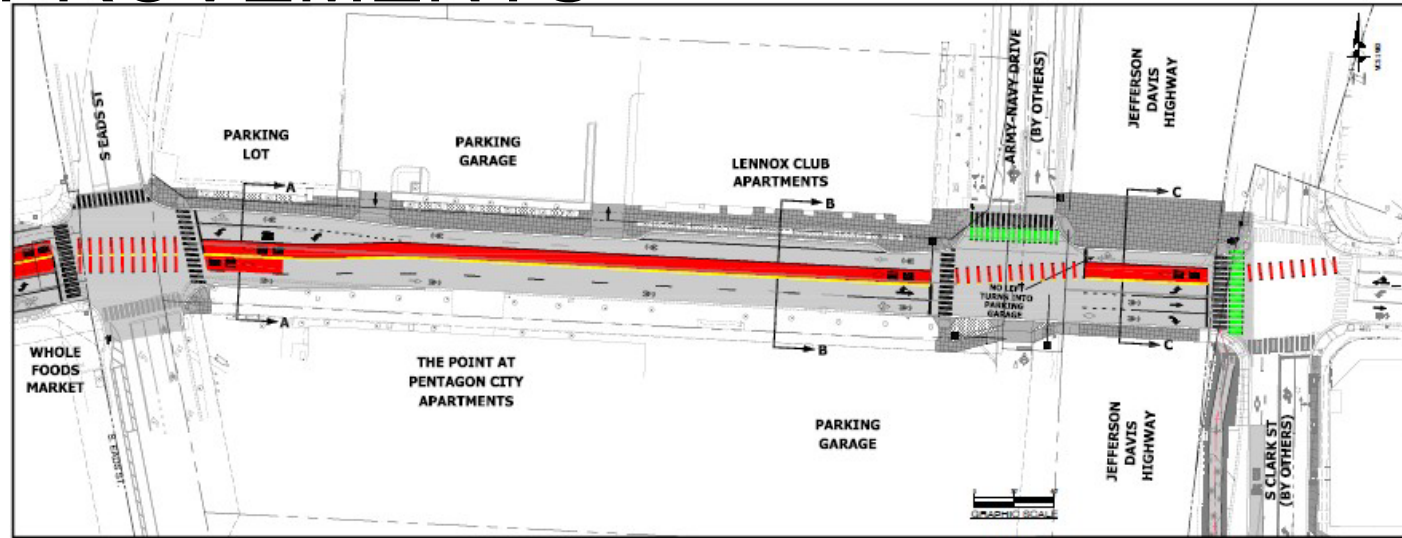

- Project Location: 12th St. South between Long Bridge Dr. and S. Eads St.
- Project Scope:
 - Overlays transitway route to Pentagon City
 - Fills on-street bike route gap in the MTP Bike Element
 - Provides corridor cross-section called for in Crystal City Sector Plan
- Planning Basis: MTP, Crystal City Sector Plan
- Project Status: In pre-construction; slated to break ground in April 2022
- Cost: Approx. \$3 million, primarily NVRTA Regional funding
- Next Public Touchpoint: Ongoing construction notices through Spring 2023

CRYSTAL CITY TO DCA MULTIMODAL CONNECTION (CC2DCA)

- Project Location: Precise alignment and facility type to be determined during NEPA concept development
- Project Scope: Provide a multimodal connection between Crystal City and DCA
- Underpinning basis: Building upon connectivity referenced in the Crystal City Sector Plan
- Project Status: NEPA Phase Alternatives Analysis
- Cost: \$38 million estimate
- Next Public Touchpoint: Public Comment on Recommended Preferred Alternative, Fall 2022



SOUTH EADS STREET - PHASE 1

- Project Location: East side of S. Eads St. between Army Navy Drive and 12th St. S.
- Project Scope: Improve sidewalk and add protected bike lane
- Underpinning basis: Master Transportation Plan, Crystal City Sector Plan
- Project Status: Completing 30% design in Spring 2022
- Cost: \$1.5 million
- Next Public Touchpoint: Communicate updates on concept design, Spring 2022

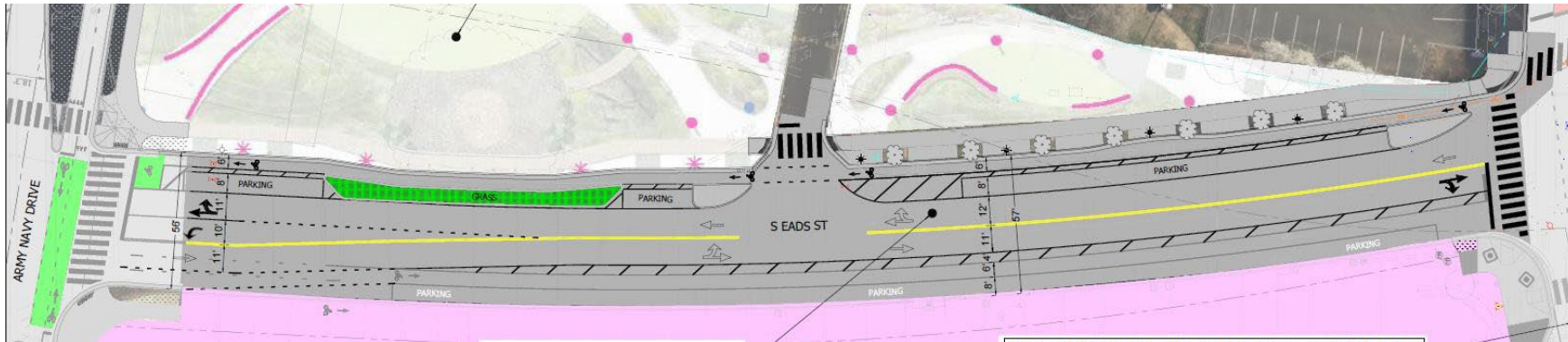

SOUTH EADS STREET - PHASE 2

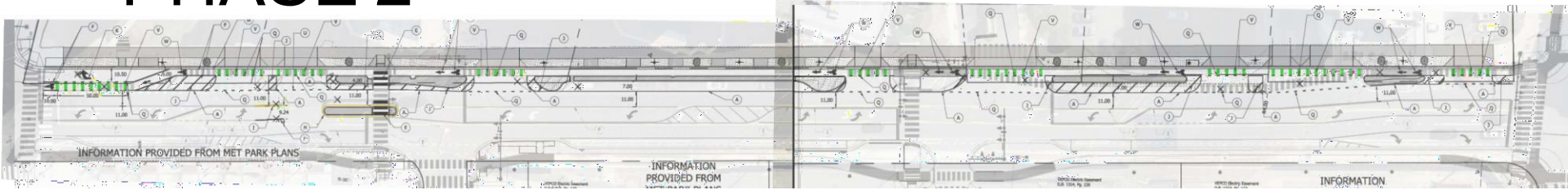

- Project Location: East side of S. Eads St. from 12th St. S. to 15th St. S.
- Project Scope:
 - Upgrade bike lane to include vertical curb protection
 - Reconstruct sidewalk and improve streetscape
- Underpinning basis: MTP Bike Element, Crystal City Sector Plan
- Project Status: 30% design public engagement completed Jan 2022.
- Design Development & Final Production to conclude by Winter 2022
- Cost: \$5 million
- Next Public Touchpoint: Communicate updates to concept design (60% design), Summer 2022

15TH STREET SOUTH PEDESTRIAN IMPROVEMENTS

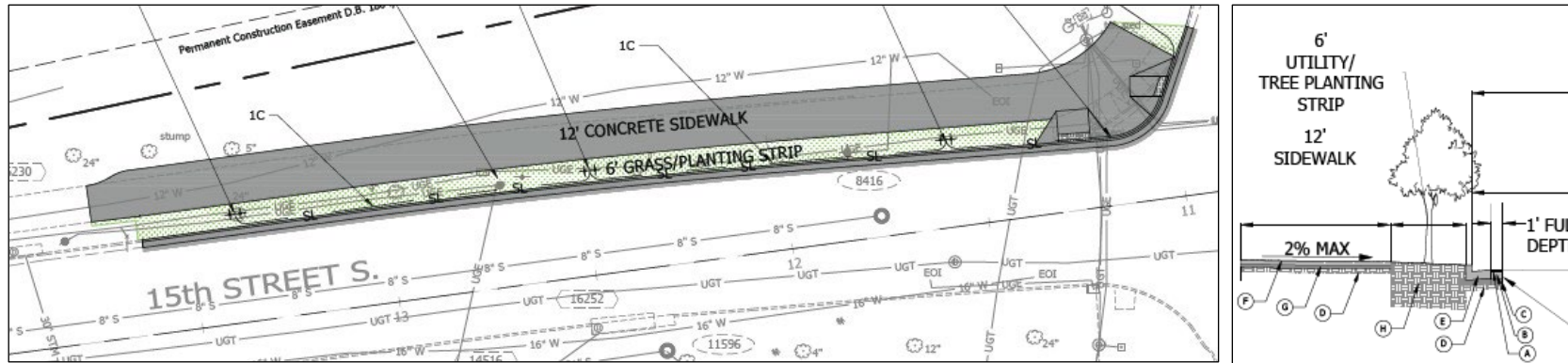

- Project Location: North side of 15th St. S. between S. Eads St. and Route 1
- Project Scope: Sidewalk improvements
 - Extents reduced to correspond with expanded scope of realigned Clark/Bell project
 - Sidewalk section expanded to 12-foot width with 6-foot planting strip
 - Reconstruct north sidewalk and improve streetscape on 15th St S.
- Planning Basis: Crystal City Sector Plan
- Project Status: In procurement through Spring 2022
- Cost: Scope reduction lowered project cost to \$400k
- Next Public Touchpoint: Construction notifications beginning Fall 2022

15TH STREET SOUTH IMPROVEMENTS

- Project Location: 15th St S. between Clark/Bell & Crystal Dr
- Project Scope: Sidewalk improvements
 - Upgrade sharrows to protected bike lanes in both directions on 15th St S
 - Reconstruct Northside sidewalk and improve streetscape on 15th St S
 - Realign 15th St S with Clark/Bell & Crystal Drive
 - Construct a Multi-use trail along west side of Clark/Bell
- Planning Basis: Crystal City Sector Plan
- Project Status: 90% Design – reworking underway
- Cost: \$12 million
- Next Public Touchpoint: Communicate updates on 90% redesign – Spring 2022

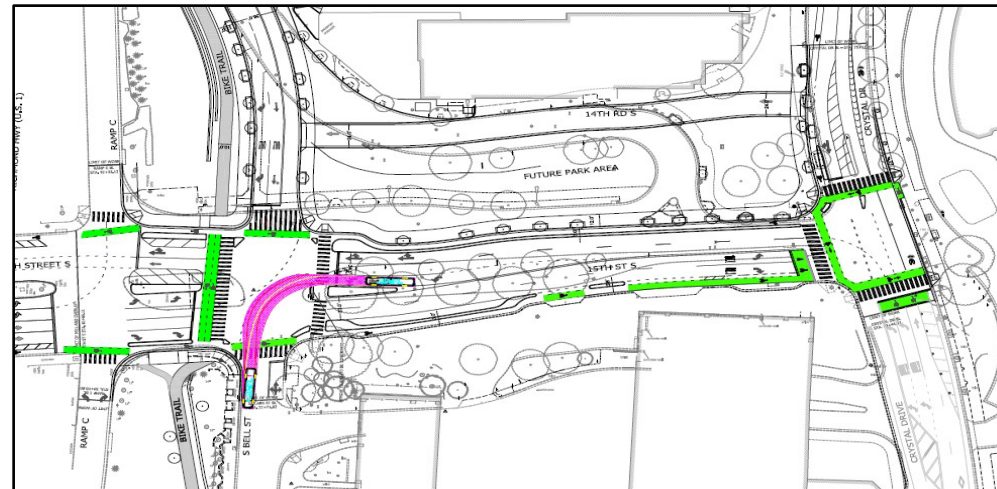

18TH STREET SOUTH COMPLETE STREET

- Project Location: 18th Street S. from S. Fern Street to S. Eads Street
- Project Scope:
 - Add protected bike lanes and upgrade streetscape
 - Realign intersection of Fern and 18th and remove slip lane
 - Reduce impervious surface, add stormwater detention, and replace a water main
- Underpinning Basis: Crystal City Sector Plan, MTP BE #3-13
- Project Status: In construction
- Cost: \$3.8 million
- Next Public Touchpoint:
Ongoing construction updates



23RD STREET SOUTH - PHASE 1

- Project Location: 23rd Street S. between S. Eads Street and Richmond Highway
- Project Scope: Improve sidewalks, streetlights and traffic signals
- Underpinning basis: Crystal City Sector Plan
- Project Status: Construction Substantially Completed
- Cost: \$1,332,000
- Next Public Touchpoint: Completion Spring 2022



AIRPORT VIADUCT PEDESTRIAN IMPROVEMENTS

- Project Location: Viaduct bridge from approx. Route 1 to George Washington Memorial Parkway
- Project Scope: Widen sidewalk along the north side of bridge
- Underpinning basis: Crystal City Sector Plan
- Project Status: Pending VDOT decision on design requirement
- Cost: \$3 million
- Next Public Touchpoint: 30% design update, TBD



POTOMAC YARD – 4MR TRAIL CONNECTION

- Project Location: Four Mile Run between Route 1 & Potomac Ave.
- Project Scope: Install trail connection from Four Mile Run Trail to Route 1
- Underpinning Basis: MTP Bike Element #1-03
- Project Status: Construction through Summer 2022
- Cost: \$1.6 million
- Next Public Touchpoint: Ongoing construction notifications



PERFORMANCE PARKING PILOT

- Project Location: Various locations (map)
- Project Goal:
 - Find out if varying meter rates with parking demand is right for Arlington
 - Possible Benefits:
 - Parking easier to find on high-demand blocks
 - More people choose to park on low-demand blocks and save money
 - Less time spent looking for parking
 - Less parking frustration
 - Less double parking
- Project Status:
 - Grant accepted by County Board.
 - Procurement anticipated Summer 2022
- Cost: \$5.4 million

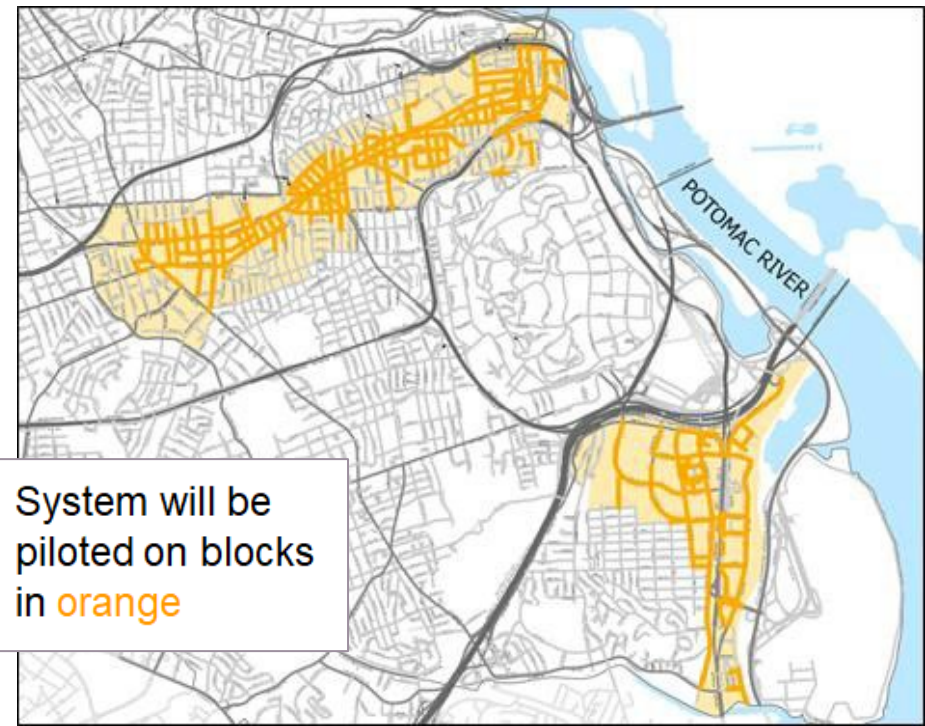

CRYSTAL CITY BIKE NETWORK

- Project Location: Crystal City east of Richmond Highway, from Alexandria border extending north to Long Bridge Park
- Project Scope: Investigate and deliver enhanced bicycle facilities by 2024 while:
 - Preserving and potentially enhancing the Crystal City-Potomac Yard Transitway
 - Balancing existing right-of-way to serve all modes of transportation
 - Align with existing transportation plans
 - Coordinate improvements with ongoing development
- Project Status: Developing final recommendations and implementation plan
- Next Public Touchpoint: Release of final recommendations

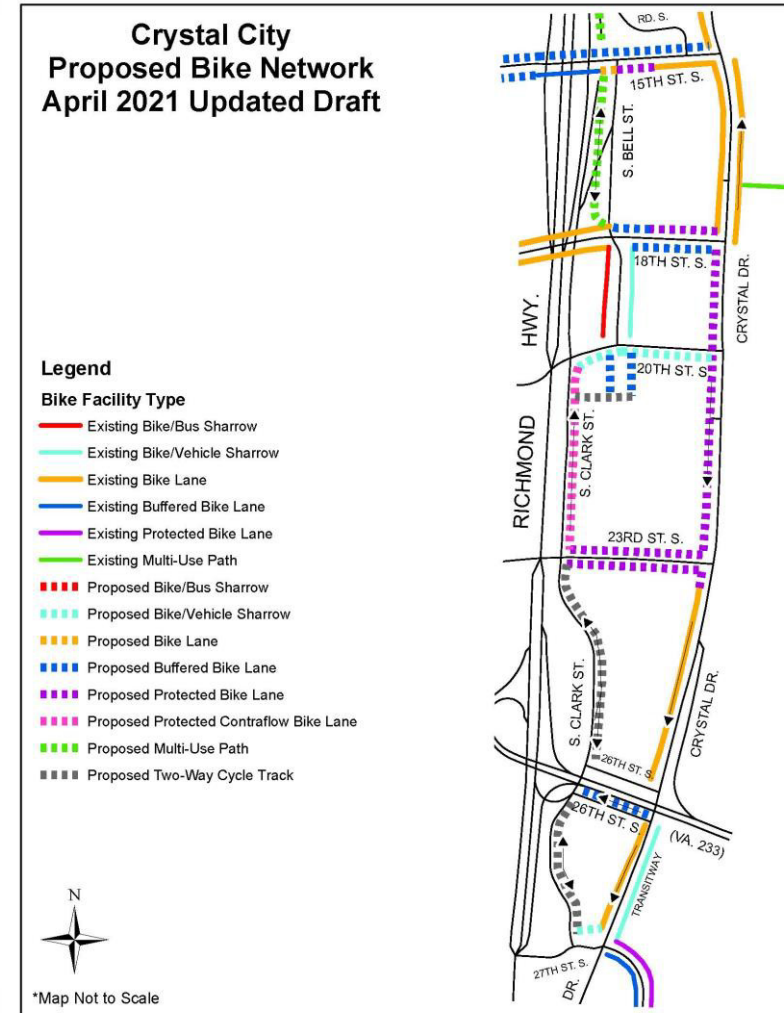

COLUMBIA PIKE MULTIMODAL – SEGMENT A EAST

Next to Arlington National Cemetery

Started: Fall 2021

Anticipated completion: Summer 2025

This work is being managed by the Federal Highway Administration as part of Arlington National Cemetery's southern expansion

Project will:

- Realign Columbia Pike from east of Oak Street to Washington Boulevard
- Modify the Joyce Street intersection and the Columbia Pike/Washington Boulevard (Route 27) interchange
- Remove a segment of Southgate Road and construct a new Nash Street
- Add a new multi-use trail next to the cemetery and pedestrian and bicycle facilities
- Build a new tunnel between the cemetery and its new maintenance compound



What to expect during construction:

- Traffic disruptions and lane closures on this section of Columbia Pike and on Joyce Street between Army Navy Drive and Columbia Pike
- During phases of work, this section of Columbia Pike will be closed, with traffic detoured via Nash Street to Southgate Road
- Sidewalk closures
- Bus stop relocations

TRANSITWAY EXTENSION TO PENTAGON CITY

Project Location Crystal Drive/12th St. between 15th St and S. Hayes St.

Project Scope Extension of existing Crystal City Potomac Yard Transitway to Pentagon City provide quality accessible transit with new stations, amenities and public art

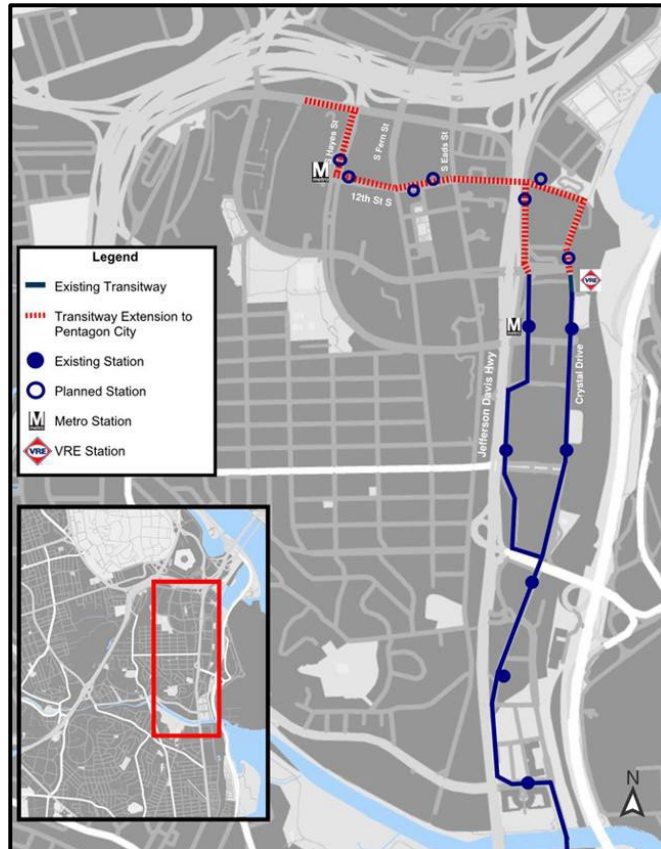

	Design	Procurement	Construction
Segment I	Spring 2021	Summer – Fall 2021	Winter 2022 ★ Start construction Spring 2022
Segment IIA	Fall 2022 ★ 60% Design completed	Winter – Summer 2023	Fall 2023
Segment IIB	Spring 2023 ★ Concept Design	TBD	TBD

Next Public Touchpoints

- Segment I: Construction updates
- Segment IIA: 60% Design engagement summary – Spring 2022

PENTAGON CITY METRO STATION SECOND ELEVATOR

- Project Location: SW corner of S. Hayes Street and 12th Street S., in front of Fashion Centre
- Project Goals & Scope: Build a new elevator providing access for passengers entering the Pentagon City Metro station from the west
- Project Status: Construction activities underway includes support of excavation; work will be completed in fall 2023.
- Cost: \$10.3 million
- Next Public Touchpoint: Ongoing construction alerts



Rendering of new elevator



Location of new elevator

PUBLIC ENGAGEMENT

FORECAST

Spring 2022

- Army Navy Drive PBL Missing Link concept engagement summary
- S. Eads Street (12-AND) Complete Streets updated concept communication
- TETPC Phase 2 design engagement summary

Summer 2022

- Crystal City 2nd Entrance 30% Design Public Meeting
- S Eads Street (12-15th) Complete Streets updated concept communication
- Army Navy Drive PBL Missing Link updated concept communication

Fall / Winter 2022

- CC2DCA Preferred Alternative Public Comment & Meeting

Construction Updates

- Ongoing, as needed

**DISCUSSION / QUESTIONS /
OTHER UPDATES**





**NATIONAL
LANDING**
PENTAGON CITY
CRYSTAL CITY
POTOMAC YARD

Tracy Sayegh Gabriel

President and Executive Director

Tracy@nationallanding.org

Robert H. Mandle

Deputy Executive Director

Rob@nationallanding.org

Malaika Scriven

VP – Planning and Development

Malaika@nationallanding.org

Matt Jones

Project Manager, Planning and Transportation

matt@nationallanding.org

Thank you